

WENDEL® LIGHTING  
**RELAMPING INSTRUCTIONS FOR  
WENLUX® 928 FRAMING PROJECTOR  
OR WENLUX® 717 ACCENT LIGHT**

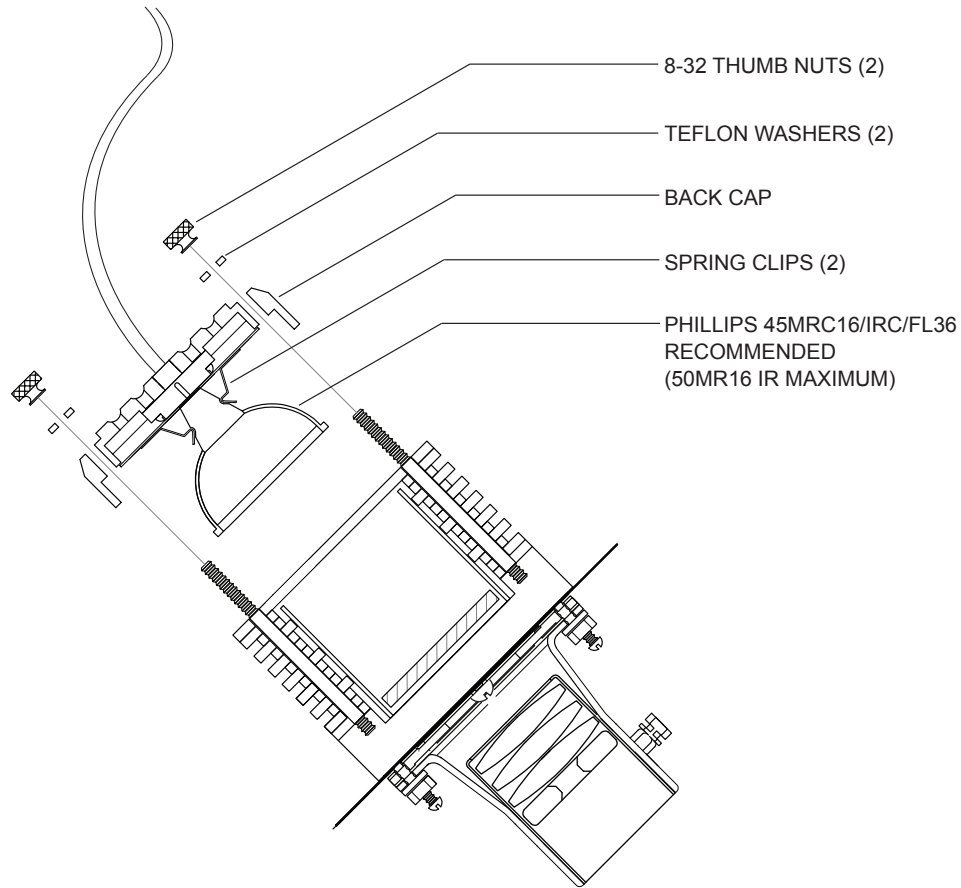

- DISCONNECT POWER
- REMOVE THUMB NUTS AND TEFLON WASHERS FROM LUMINAIRE AND REMOVE BACK CAP
- GENTLY REMOVE LAMP FROM CAP BY PULLING FREE FROM SPRING CLIPS
- GENTLY CLIP REPLACEMENT LAMP INTO CAP AND RESECURE LUMINAIRE BACK CAP TO LUMINAIRE BODY BY RETURNING TEFLON WASHERS AND TIGHTENING THUMB NUTS