

# WENDELIGHTING®

DIVISION OF JACKSEN INTERNATIONAL LTD

Wenlux® 717ML  
Monopoint Accent Light  
LED

The Wenlux® 717ML is a Surface Accent light with a Monopoint mounting system. A white high color rendering LED light was discriminately selected to enhance fine art and furnishings.

The Wenlux LM2 (2 wire) and LM4 (4 wire) Lighting Modules are inseparable. The LM Lighting Modules include the driver, LED Chip, proprietary optics and cooling system. Lighting Modules accept the Accent Light (Adapter Cone) to which a series of adjustable Lens Holder Tubes with spherical lenses are positioned within to optically control variable beam spreads. Beam spreads can be further altered using Light Control Accessories. Multiple Light Control Accessories can be positioned within the rotational Lens Holder Cone.

717ML provides rotational adjustment using lockable fastening systems. A dual heat sink technology provides optimum LED cooling. A 4" square deep junction box is provided to house the LED Driver hidden above ceiling. The separable J-Box includes an adjustable mud ring and accommodates a ceiling thickness from 5/8" to 1-1/4".



Wendelighting reserves the right to make changes without notice.

## LM2P LIGHTING MODULE SPECIFICATIONS (CA T24-JA8)

- Power:** 120/277 VAC Input - 20 Watts
- J-Box:** Deep Junction Box on Mounting Platform with Adjustable Mud Ring Included
- Driver/LED:** LM2P with 2790 Chip and Primary Optics JA8 Tested - 1300 Lumens @ 500mA (for tested life) - 67 Lumens/Watt (Estimated 1200 Lumens @ 450mA) JA8 Allowance on all LED Chip Options
- Optics:** Proprietary
- Luminaire:** Aluminum
- Dimmer:** 2 Wire Forward / Reverse Phase
- Mounting:** Ceiling - Wall
- Listings:**
  - UL / CUL - Damp Location - Dead End or Daisy Chain Feed Through Class 1 Wiring Only (No Additional Conductors)
  - California Title 24 Residential Lighting JA8 Recessed Tested Listing (See [wendelighting.com/resources](http://wendelighting.com/resources))

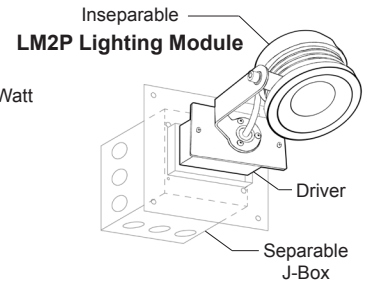

## MONOPOINT ACCENT LIGHT OPTIONS

717	ML	LM	LED Chip Options (Chip Values) (@ 450mA:)	Optical Lens Holder Tube (Beam Spread):	Fixture Color:	Light Control Accessories:
<b>Adapter Cone:</b>  <b>Accent Light</b>	<b>Monopoint Canopy Shape:</b>  <b>SQ</b> Square  <b>RD</b> Round  <b>RC</b> Rectangular	<b>Lighting Module: (By Driver Type)</b>  <b>LM2P</b> (Standard) Philips Xitanium 2 Wire Driver Forward / Reverse Phase Dimmable 2% Use ELV Dimming 120/277V In 450mA Out Listed with CA Title 24 JA8  <b>LM4L</b> Lutron EcoSystem PEQ0 4 Wire Driver Dimmable 0.1% 120/277V In 450mA Out Requires EcoSystem Dimming Listed with CA Title 24 JA8  <b>LM2H</b> Hatch LC25-0500P 2 Wire Driver Forward / Reverse Phase Dimming 18% 120V In 450mA Out LM Not Listed with CA Title 24 JA8 Use Reverse Phase for Low Loads	<b>2798</b> 2700K 98 CRI 1400 Lumens R9 93  <b>3098</b> (Standard Chip) 3000K 98 CRI 1500 Lumens R9 88  <b>2790</b> 2700K 90 CRI 1600 Lumens R9 54  <b>3090</b> 3000K 90 CRI 1700 Lumens R9 60	<b>NBS</b> 14° - 28°  <b>MBS</b> 30° - 40°  <b>WBS</b> 50°  <b>VWB</b> 63°	<b>ALU</b> Natural Aluminum  <b>BLK</b> Black  <b>WHT</b> White	<b>FI</b> h In® 0° Softening Lens  <b>SF</b> 14° Soft Focus Lens  <b>SL</b> 28° Spread Lens  <b>RL</b> 0° x 48° Rectilinear Lens  <b>HL</b> Hexcell Louver  <b>1F</b> 100 Kelvin Warming Filter 39mm Diameter

**Color Filter Options:** Additional 39mm Diameter Dichroic Color Filters Available Through Rosco

Philips and Xitanium are Trademarks of Signify  
Lutron, Hi-Lume, Tu-Wire, and EcoSystem are Trademarks of Lutron Electronics Co., Inc.

WENDELIGHTING / DIVISION OF JACKSEN INTERNATIONAL LTD. - P.O. BOX 337 - 363 BELL STREET - LOS ALAMOS, CALIFORNIA 93440  
(800) 528-0101 Fax (626) 303-0046 [www.wendelighting.com](http://www.wendelighting.com) e-mail: [info@wendelighting.com](mailto:info@wendelighting.com)

Copyright © 2018 Jacksen International. Ltd. All rights reserved

# Wenlux® 717ML Monopoint Accent Light LED

## ATTIC AND BUILDING ENVELOPE INSTALLATION

MINIMUM R38 INSULATION SURROUNDING AND COVERING RECESSED J-BOX REQUIRED FOR ASSEMBLY LIFE

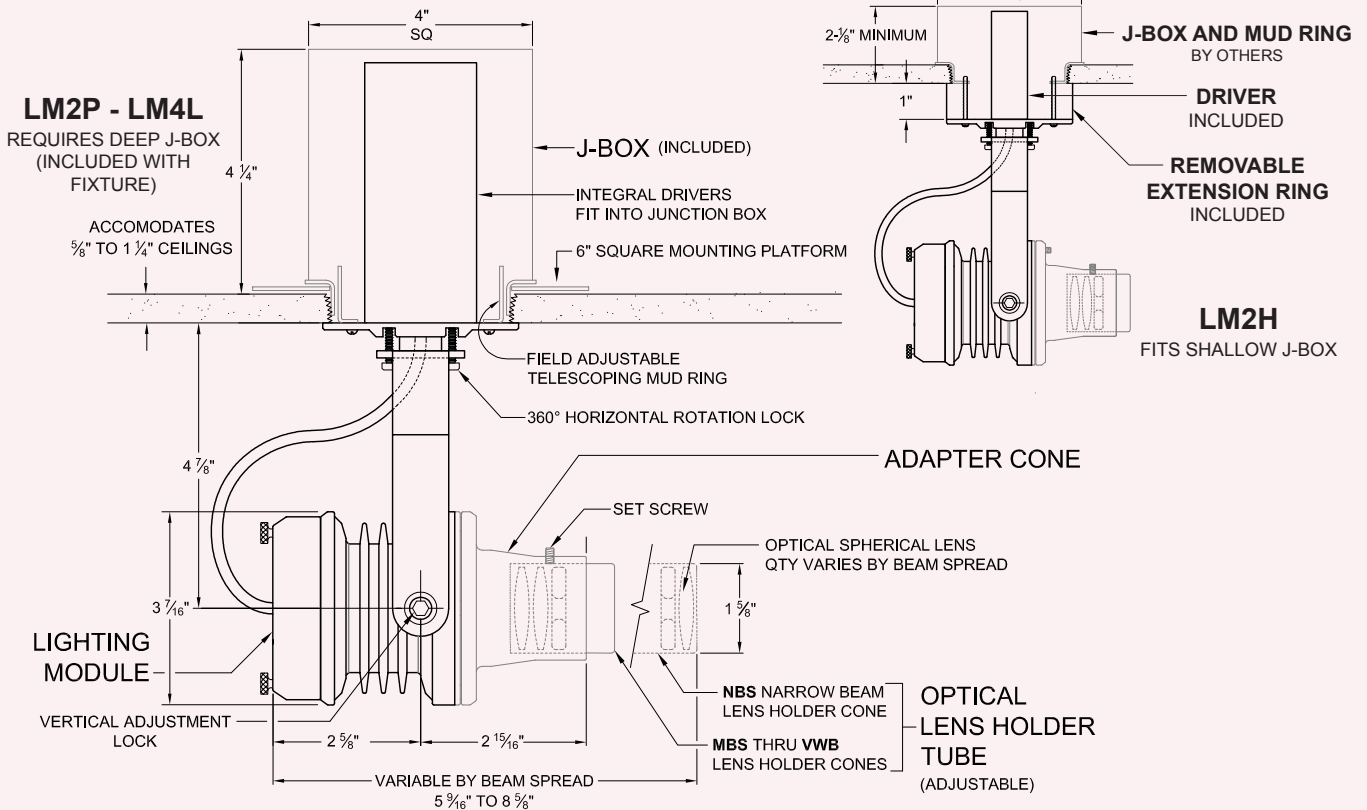

## SPECIFY CANOPY SHAPE

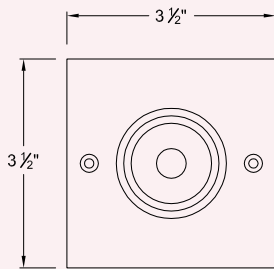

**SQ**  
**SQUARE**

FITS 3" DIAMETER MUD RING OVER DEEP J-BOX

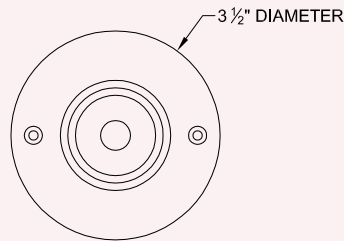

**RD**  
**ROUND**

FITS 3" DIAMETER MUD RING OVER DEEP J-BOX

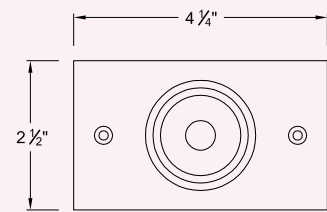

**RC**  
**RECTANGULAR**

FITS 2-1/4" x 3-3/4" SINGLE DEVICE MUD RING OVER DEEP J-BOX

## LIGHT CONTROL ACCESSORIES

Degrees shown are approximate on a NBS Cone. Results may vary substantially using wider MBS thru VWB beam spread Cones.



0°  
Fade In® Softening Lens  
**FI**

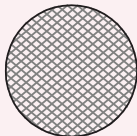

14°  
Soft Focus Lens  
**SF**

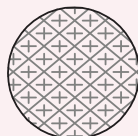

28°  
Spread Lens  
**SL**

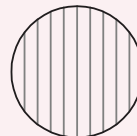

0° x 48°  
Rectilinear Lens  
**RL**

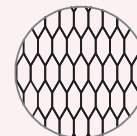

Hexcel Louver (Black)  
**HL**

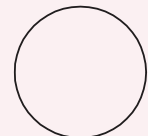

100 Kelvin Warming Filter  
**1F**

### HOW TO SPECIFY

To specify, please visit [www.wendelighting.com/art-light-worksheets/](http://www.wendelighting.com/art-light-worksheets/) complete the appropriate Art Lighting Worksheet and forward the completed worksheet to our staff members at [info@wendelighting.com](mailto:info@wendelighting.com).

WENDELIGHTING®



The name Wendelighting is a registered trademark to Jacksen International Ltd., Monrovia, California. The name encompasses Wendel® and Wenlux® optical projectors as well as other types of Wendel/Wenlux lighting fixtures for both interior and exterior use.

DIVISION OF JACKSEN INTERNATIONAL LTD